

TCM4

RFID Multi Frequency Technology Card Reader



Distributed by Katun



The small-sized TCM4 readers of multi-frequency contactless cards are compatible with most of the cards on the market in 13.56 MHz, 134.2 or 125 KHz. By default, they emulate an USB keyboard and therefore do not require driver setup on Window PCs and MFPs.

The TCM4 offers a Bluetooth option.

Application Fields

Secured print: direct connection to the USB port of many multifunction for identifying the user and release the prints (with Print2me function available) or making copies.

Option for the cPad terminal: integrated into the designed shape of the cPad, the TCM4 enables the user to be identified by using a card with a solution like Gespage, PaperCut, performing print management within an organization.

PC Applications: RFID tag entry, enrollment of a user's card in a database, secured access to some applications.

A TCMxManager application is designed and available at no cost for the technical people to easily analyze the card reader, promptly configure it and replicate on a pack of TCM4 card readers.



MFP/Printer



PC



Touchscreen



Access



Time Clock



Charger



Car Park



Restaurant

KATUN[®]

TCM4

RFID Multi Frequency Technology Card Reader



Distributed by Katun

- ✓ Identification using an Android or iOS smartphone is possible using the CartadisID application available for free from device app stores.
- ✓ This application allows you to select NFC and/or Bluetooth technology, click and/or contact identification.
- ✓ Identification on iOS and click mode requires the Bluetooth option.

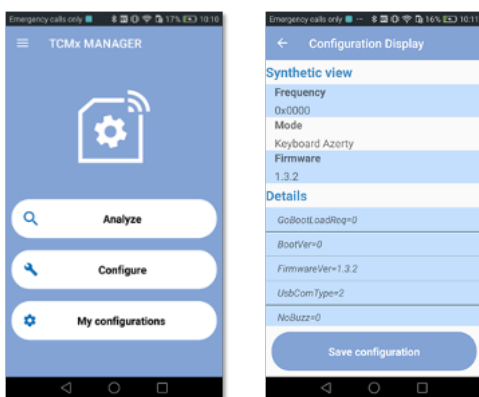
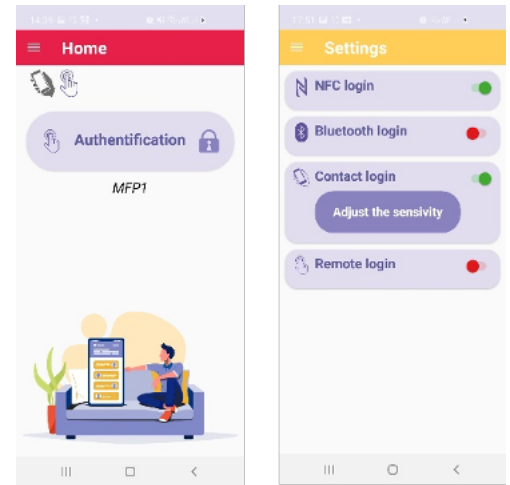

- ✓ The TCMxManager configuration application supplied as standard allows you to easily install the TCM4 card readers, modify all the parameters and apply transformation filters for card identifiers.
- ✓ TCMxManager runs on Android.

Specifications

Compatibility with the following cards (partial list):

13.56MHz

ISO14443-A: MIFARE (Classic, DESFire, A ATQA, Plus S, X, Pro X, Smart MX, Ultralight...), LEGIC Advant, HID iCLASS SEOS.
ISO14443-B: Calypso, HID iCLASS.
ISO18092: NFC, Sony FeliCa.
ISO15693: LEGIC Advant, HID iCLASS, iCLASS SE/SR/Elite (UID only), ICODE SLI - Cartadis ID

125kHz/134.2kHz

EM4100, EM4102, EM4105, EM4200, EM4305, FDX-B, HID xxProxx, StartProx, Hitag 1&2, Indala.

- ✓ **Bluetooth Option:** Android and IOS authentication using Bluetooth. ✓ **Equipped with Led indicators and a buzzer for power-on and reading.**
- ✓ **The interface operates up to 10 cm (according to the transponder).** ✓ **Warranty: 12 months**
- ✓ **Dimensions:** L = 80 mm; H = 50 mm; Depth = 15 mm; Weight = 50 g.

Katun P/N	Description
52669	TCM4 card reader, Non-Bluetooth, Includes an adaptor usb female to mini usb male.
52932	TCM4 card reader, with Bluetooth, Includes an adaptor usb female to mini usb male.
53594	TCM4 card reader, Non-Bluetooth, for HP devices, for installing on the Hardware Integration Pocket (HIP)
52671	Contactless Mifare cards

Contact your Katun Sales Representative today for more details.
Order now via the Katun Online Catalogue.

www.katun.com

KATUN®